

Basic function parameters	
Rated power kW	0.1
Rated voltage V	220
Rated current A	1.27
Peak current at rated speed A	4.78
Rated torque Nm	0.32
Peak torque at rated speed Nm	1.12
Rated speed rpm	3000
Max speed rpm	7000
Rotor inertia $\text{kg} \cdot \text{cm}^2$	$0.072 \pm 10\%$
Encoder resolution	23bit
Insulation class	F(155)
Protection class	IP67
Static torque of brake Nm	/
Brake power supply V	/
Brake backlash°	/
Duty cycle	S1
Radial load N	≤ 78
Axial load N	≤ 54

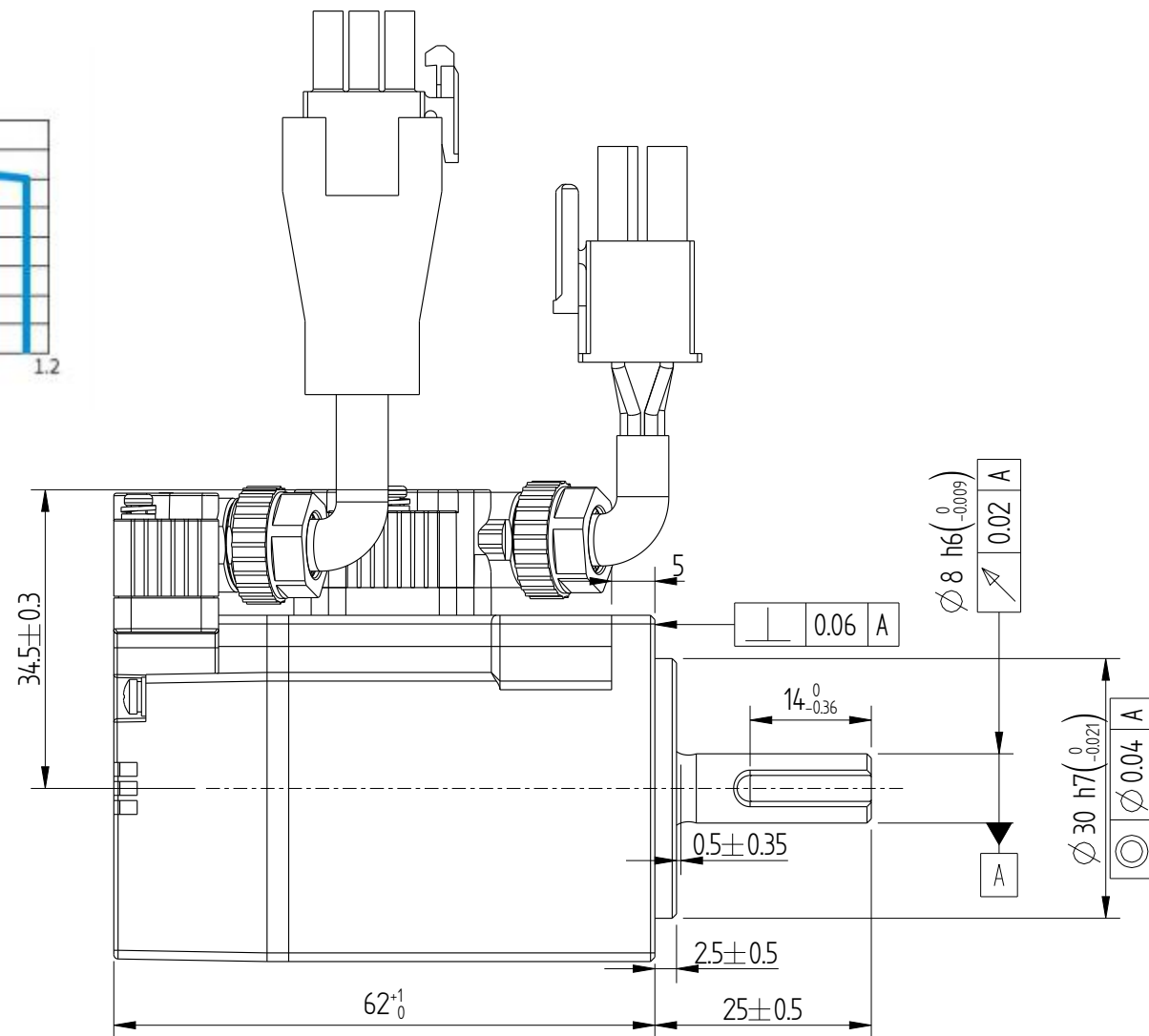

A diagram of a 2x3 grid of drawers. The drawers are numbered 1 through 6. The top row contains drawers 4 and 1, and the bottom row contains drawers 5 and 2. A handle is shown on the left side of the grid.

7pin termina	1	4	3	6	9	8	7
Core color	blue	blue black	yellow	yellow black	red	black	Ground wire
definition	DC+	DC-	PS+	PS-	+5V	0V	shield
	Pair		Pair		Pair		

6pin terminal	5	4	2	1
Core color	chartreuse	red	black	white
definition	PE	W	V	U

Technical drawing of a motor assembly. The motor is a rectangular unit with a circular output shaft on the left. A cable gland is mounted on the top of the motor, and a cable with a strain relief is connected to it. The cable has a braided shield and a multi-pin connector. The drawing is a line drawing showing the motor, the cable gland, and the cable with its strain relief.

0111A169-WX

Mark



INOVANCE

Model

MS1H4-10B30CB-A330R-S-INT